

POSTER HANGING RAIL INSTALLATION INSTRUCTIONS

PHOTOWALL

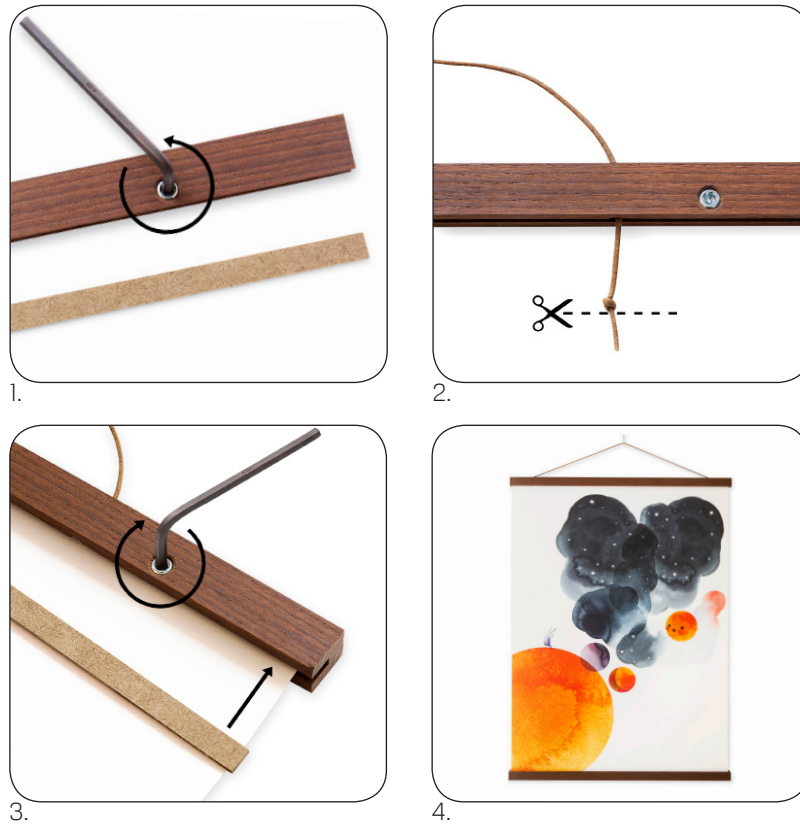

CONTENTS

Wooden moldings, 2 pcs
Cord, 63 Inches
Allen wrench, 1 pc
Nail for hanging, 1 pc



See our instruction video:
www.photowall.com/us/our-products/product-information-posters

MOUNTING

1. Start by loosening all screws a bit, so that the middle strips can be removed.
2. Take the wooden molding with two holes and slide the cord from the top through one of the holes. Tie a knot at the end of the cord, cutting off the stump near the knot. Pull the knot into the hole.

Select the length you want on the cord, and do the same at the other end of the molding.

3. Set the wooden molding with the cord on a table, with the screws facing upward. Slide the upper edge of the poster into the groove of the molding (with the image facing downward and the back side facing upward). Then, thread the middle strip into the groove and tighten the screws so that the poster is locked into place.

Repeat this procedure with the second molding.

4. Attach the nail to the wall and hang up your poster.

Nice! Well done!



Share your images with us!

We would love to get a glimpse of your style. Share your images on Instagram with @photowall_sweden and #photowallsweden.